

1st International Symposium on Affective Engineering 2013

March 6 (Wednesday)-March 8 (Friday), 2013

06-3		
15:00 - 18:00		Registration
18:00 - 20:00	Flamingo Cafe	Welcome Reception (Flamingo Cafe)

07-3		
9:00 - 17:30		Registration
9:00 - 9:30	International Conference Hall	Opening
9:30 - 10:30	<p>KEYNOTE International Conference Hall Chair Junzo WATADA</p> <p>Building machines in the biological way: reactivity and emotions first, reasoning later</p> <p>Dr. Horia-Nicolai L. Teodorescu Professor, Gheorghe Asachi Technical University of Iasi</p>	
10:30 - 10:50		Coffee Break
10:50 - 11:50	<p>KEYNOTE International Conference Hall Chair Hisao SHIIZUKA</p> <p>Emerging New Rules of Games in Design</p> <p>Dr. Kumpyo Lee Executive Vice President Head, Corporate Design Center, LG Electronics</p>	
11:50 - 13:30		Lunch
		Lunch
		11:50 - 13:30
		Lunch
		11:50 - 13:30

13:30 - 14:50 (20 min * 4) Room:C21-1	Session 1A	1A-1	Creating Upper Garments with Tight Sleeves Considering Individuals' Figures by Automatic 3D Pattern-making Yo TAKAHASHI, Akito SORJIE, KyoungOk KIM, Masayuki TAKATERA
		1A-2	Draping Simulation by a Mapping Method Shigeru INUI, Yosuke HORIBA, Yoko MESUDA, Mariko INUI
	Chair Masayuki TAKATERA	1A-3	Cutting Method for Cloth Handling Yuko MESUDA, Shigeru INUI, Yosuke HORIBA
		1A-4	Fitness Comparison of Commercial Jodhpurs Using 3D Scan Data Mi Jung KANG, Young-Ah KWON
14:50-15:10	Coffee Break		
15:10-16:30 (20 min * 4) Room:C21-1	Session 2A	2A-1	Research on jacket patterns and specifications of ready-to-wear for high-end in Italy and Japan Tsuyoshi OTANI, KyoungOk KIM, Keiko MIYATAKE, Kimiko SANO, Masayuki TAKATERA
		2A-2	Comparison of high-end tailored jackets for ready-to-wear produced in Italy and Japan Tsuyoshi OTANI, KyoungOk KIM, Keiko MIYATAKE, Kimiko SANO, Masayuki TAKATERA
	Design / Fashion	2A-3	Fit Satisfaction and Design Preference for Jodhpurs Ji-Eun LEE, Young-Ah KWON
		2A-4	Relationships between an Individual's Fabric Identification Ability and Amounts of Experience and Knowledge Tomoharu ISHIKAWA, Kou SATO, Ryouta TSUJI, Kazuya SASAKI, Hiroko SHIMIZU, Miyoshi AYAMA
Chair Se-Yeon Yoon			
16:30-16:50	Coffee Break		
16:50-17:50 (20 min * 3) Room:C21-1	Session 3A	3A-1	A method of analyzing the results obtained through the Impression evaluation method considering the vagueness of Kansei Shunsuke AKAI, Teruhisa HOCHIN, Hiroki NOMIYA
		3A-2	A case study on elegance of a jacket appearance using images and silhouette of jackets KyoungOk KIM, Asako NOZAWA, Tsuyoshi OTANI, Masayuki TAKATERA
	Image Analysis	3A-3	Automatic Image Description Generation in Japanese Using Web-scale Image Dataset Tomohiko OZAWA, Masafumi HAGIWARA
Chair Masafumi HAGIWARA			
18:00	The exit of Conference Hall		
19:00 - 21:00	Moji Hotel 2F		

13:30 - 14:50 (20 min * 4) Room:C21-2	Session 1B	1B-1	An Assessment of Workload on Upper Limbs and Design for Burden Reduction When Caregiver Change the Nursing Trousers Kazuki URYU, Megumi KOKATSU, Satoshi HOSoya, Chiyoumi MIZUTANI
		1B-2	Performance matrix approach to generating an alternative plan in consensus building Keiichi YASUDA, Wataru SHIRAKI, Hitoshi INOH
	Design Evaluation	1B-3	Preliminary Research on Physiological Response to Pleasant Tactile Properties of Towels Ya-Ning LI, Masayoshi KAMIDO, Tomomi TSUGAMA
		1B-4	Evaluation of comfortable sensation when wearing a cosmetic facemask Motoki HIROSE, Mika MORISHIMA, Hiroaki YOSHIDA, Masayoshi KAMIDO, Yoichiro KAWAHARA
Chair Shin'ya NAGASAWA			
14:50-15:10	Coffee Break		
15:10-16:30 (20 min * 4) Room:C21-2	Session 2B	2B-1	Independence of anisotropy and depth reversal in apparent depth specified by binocular disparity and motion parallax Yasuaki TAMADA, Masayuki SATO
		2B-2	Streetscape Zoning for Historical Town by Self Organizing Maps Toshio TSUCHIYA
	Model	2B-3	Shall We Let Algebraic Agents Play a Board Game ? Kentaro ENDO, Tetsuya MURAI, Yasuo KUDO, Mayuka F. KAWAGUCHI, Nam Van HUNH
		2B-4	Convergence of a Newton-Like Algorithm Solving the Nonlinear Complementarity Problem Vyacheslav V. KALASHNIKOV, Nataliya I. KALASHNYKOVA
Chair Hyo-Il Jung			
16:30-16:50	Coffee Break		
16:50-17:50 (20 min * 3) Room:C21-2	Session 3B	3B-1	A Study on Fashion Coordination Support System Yuu TANABE, Hiroko SHOJI
		3B-2	Structure of Feeling Kawaii Hisao SHIZUKA
	Kawaii	3B-3	Rules of Kawaii Michiko OHKURA
Chair Michiko OHKURA			

13:30 - 14:50 (20 min * 4) Room:C22	Session 1C	1C-1	Theoretical Effects Generation Based on Adjectives Representing Impressions of Story Scene Keinichi ISHIZUKA, Takehisa ONISAWA
		1C-2	Using Robots to Estimate Children's Personalities Akiko IWASAKI, Takayuki SHIMOTANI, Kazumi ABE, Tomoaki NAKAMURA, Takayuki NAGAI, Takashi OMORI
		1C-3	Estimation of Dialogue Moods Using the Prosodic Fluctuation Features Kaori TOYODA, Shohei KATO
Chair Akihiro OGINO			
14:50-15:10	Coffee Break		
15:10-16:30 (20 min * 4) Room:C22	Session 2C	2C-1	The Influence of Skincare Routine on Skin Physiology Parameter and Kansei-Value Yuet-Sim CHAN, Yukiko TAMURA, Misako KURODA, Takao SOMEYA
		2C-2	Development of the Skin Counseling Equipment in which Counselor's Experience and Sensitivity are Reflected Takayoshi ITO, Sumiko SATO, Yuet-Sim CHAN, Takao SOMEYA
	Branding and Design Products Affective Products	2C-3	An Analysis of Reading Emotion of e-Books with Sound Effects by Near-Infrared Spectroscopy (NIRS) Katsuari KAMEI, Akira NAGAI
		Chair Katsuari KAMEI	
16:30-16:50	Coffee Break		
16:50-17:50 (20 min * 3) Room:C22	Session 3C	3C-1	Unveil the Competitive Advantage of Richemont over LVMH Shinichiro TERASAKI, Shinya NAGASAWA
		3C-2	A Fashion Coordinate Support system Based on the Visualization of Impression Differences Yutshiro KINOSHITA, Junji YOKOYAMA
	Affective Products	3C-3	A Proposal of Kansei Evaluation for Traditional Vietnamese Aodal Clothes based on Computer Vision Thang CAO, Youkinobu HOSHINO
Chair Katsuari KAMEI			

The free bus departs at 18:00 at the exit of Conference Hall

BANQUET (Moji Hotel 2F)

08-3		Registration			
9:00 - 16:30	Session 4A	Using Feature Values of Statements to Improve the Estimation Accuracy of Factor Scores of Impressions of Question and Answer Statements Yuya YOKOYAMA, Teruhisa HOCHIN, Hiroki NOMIYA, Tetsuji SATOH	Session 4B	4B-1	The Research of Questionnaire Survey for Culture Characteristics Improvement in the Concrete Kotaro MATSUMURA
10:00 - 11:20 (20 min * 4) Room:C21-1	Text Mining	4A-2	Affective Engineering	4B-2	Reviewing the Role of the Science Fiction Special Interest Group in User Interfaces: Case of the Science Fiction Movie Shigeyoshi IIZUKA, Jun ITO, Hideyuki MATSUBARA
		4A-3		4B-3	The Study for the Tendency and the Trend of Global Smart phone Won-Il KWAK, Jong-Pyo HONG
	Chair	4A-4	Chair	4B-4	Forecasting Emotions Provoked by Perception of Mandala Patterns based on Electroencephalogram Components Chih-Wei CHEN, Yung-Chin HSIAO, Junzo WATADA
		CP Lim		Hiroki BAN, Takashi OYABU	
11:20 - 13:30	Session 5A	Mu Rhythm Suppression during Observing Group Action Hiroki TOMIHARA, Kenta HABUCHI, Hiroko WADA, Damee CHOI, Midori MOTOI, Takayuki NISHIMURA, Shigeki WATANUKI, Yeon-Kou KIM	Session 5B	5B-1	A Research on Characteristics of Behaviors Appearing in Coloring - Differences in Coloring Behaviors by Contexts of Contour Images WonSeok YANG, Toshimasa YAMANAKA
13:30 - 14:50 (20 min * 4) Room:C21-1	Brain /Bioinstrumentation 1	5A-2	Color	5B-2	Influence of focal colors in color memory Hiroaki MIYAKE, Atsushi OSA, Takeshi KINOSHITA
		5A-3		5B-3	Experiencing Color Environments by Different Age Groups: Tapping into the Potentials of VR Simulation So-Yeon YOON, Don-Han KIM
	Chair	5A-4	5B-4	The Effect of Color, Material, and Finishing (CMF) on Emotional Characteristics of White Products Nooree NA, Hyeon-Jeong SUK	
14:50 - 15:10	Session 6A	Autonomic Nervous Response depending on Cultural Familiarity during Watching Movie Wuon-Shik KIM, Hyuong-Min CHOI, Dahnun KIM, MinhoSONG, Gi Yong NOH	Session 6B	6B-1	The Evaluation of Informational and Emotional Appeals of Plant Factory TV Commercials on Purchase Intention and Favorability Xiaofan ZHANG, Zhenwei YOU, Kenta ONO, Heruo HIBINO, Shinichi KOYAMA
15:10 - 16:30 (20 min * 4) Room:C21-1	Brain/ Bioinstrumentation 2	6A-2	Subjective Evaluation	6B-2	Comparison of Electronic Textbook and Paper Textbook from the perspective of Users' Stress and their Evaluation Yusuke NAGAMORI, Mizuki NAKAJIMA
		6A-3		6B-3	A Study on Preference of Shuso Japanese Paper - Comparison of Japan, China and France- Hongguang HU, Yuka TAKAI, Noritaka SAIKI, Akihiko GOTO, Hiryuki HAMADA
16:30 - 17:00	Min-Cheol Whang	6A-4	Chair	6B-4	Interactive Tabu Search for Creating Fragrance Suited to User's Preference Makoto FUKUMOTO, Keiji KAWAI, Makoto INOUE, Jun-ichi IMAI
				Vyacheslav V. KALASHNIKOV	

08-3		Closing			
11:20 - 13:30	Lunch				
13:30 - 14:50	Lunch				
14:50 - 15:10	Coffee Break				
15:10 - 16:30	Coffee Break				
16:30 - 17:00	Coffee Break				

1st Floor Layout

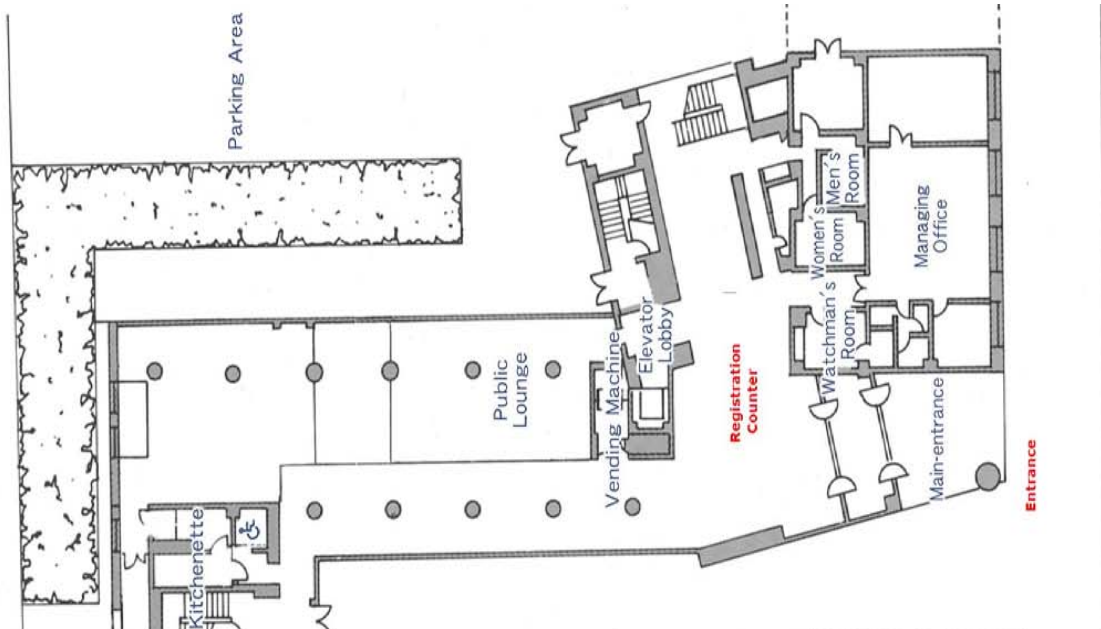

2nd Floor Layout

